

Free-sliding module with Flintec SB4 bending beam load cell

Picture is a representation of actual product.

Load Cell Approvals

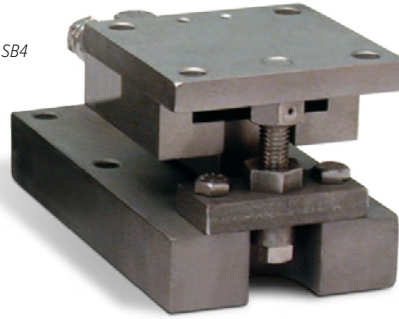

Complete Kit Includes

- One JB4SS NEMA Type 4X stainless steel signal trim junction box
- One fixed-pin module, one side-stop module, and one or two free-sliding assemblies. Each module is complete with a Flintec SB4 or SB10 stainless steel hermetically sealed load cell
- 25 ft of hostile environment EL147HE SURVIVOR® load cell cable

Standard Features

- Capacities (per module): 5 kN to 100 kN
- Unique design allows for thermal expansion/contraction
- Jacking screw allows empty vessel to be lifted clear of load cell for maintenance
- Unique blind load hole eliminates unwanted side and eccentric loads
- Vessel is free to slide laterally on PTFE-coated surfaces
- Load cell outputs are matched to $\pm 0.07\%$ allowing replacement without further calibration

Optional Features

- NTEP Certified load cells available: Capacities 1,125 to 11,250 lb

Applications

- Light- to medium-capacity tanks and hoppers
- Mixers and blenders
- Process measurement and control

WEIGH MODULES

Order Information

| Load Rating (Per Module) | Part # | Price |
|--|--------|---------|
| NTEP Certified 3-Module Kit | | |
| 5 kN | 29871 | Consult |
| 10 kN | 29872 | Consult |
| 23 kN | 29873 | Consult |
| 50 kN | 29874 | Consult |
| NTEP Certified 4-Module Kit | | |
| 5 kN | 29875 | Consult |
| 10 kN | 29876 | Consult |
| 23 kN | 29877 | Consult |
| 50 kN | 29878 | Consult |
| Non-NTEP Certified 3-Module Kit | | |
| 2.3 kN | 38205 | Consult |
| 5 kN | 17977 | Consult |
| 10 kN | 17978 | Consult |
| 23 kN | 17979 | Consult |
| 50 kN | 17980 | Consult |
| 100 kN | 17981 | Consult |

| Load Rating (Per Module) | Part # | Price |
|---|--------|---------|
| Non-NTEP Certified 4-Module Kit | | |
| 2.3 kN | 38206 | Consult |
| 5 kN | 17984 | Consult |
| 10 kN | 17985 | Consult |
| 23 kN | 17986 | Consult |
| 50 kN | 17987 | Consult |
| 100 kN | 17988 | Consult |
| Conduit Adapter Kit (must be factory installed to maintain warranty) | | |
| 1/2-14 NPT | 17703 | Consult |

Paramounts® HS

Hermetically Sealed, Mild Steel, Light- to Medium-capacity Tank Weighing Systems

Dimensions

| Rated Capacity | C | D | H | H1 | *H2 | **H2 | H3 | L | L1 | L2 | L3 | L4 | W | W1 |
|----------------|------|------|------|------|------|------|------|-------|------|------|------|------|------|------|
| 2.3 kN | 0.38 | 0.44 | 3.49 | 1.00 | 0.50 | 0.75 | 2.98 | 7.51 | 3.00 | 4.00 | 3.00 | 0.50 | 4.00 | 3.00 |
| 5 kN to 23 kN | 0.44 | 0.44 | 3.58 | 1.25 | 0.50 | 0.75 | 3.06 | 7.51 | 3.00 | 4.00 | 3.00 | 0.50 | 4.00 | 3.00 |
| 50 kN | 0.56 | 0.56 | 4.66 | 1.50 | 0.62 | 1.00 | 4.09 | 9.19 | 3.87 | 5.00 | 3.87 | 0.56 | 5.00 | 3.87 |
| 100 kN | 0.69 | 0.69 | 6.41 | 2.00 | 0.75 | 1.25 | 5.73 | 11.46 | 4.75 | 6.00 | 4.75 | 0.69 | 6.00 | 4.75 |

* Side-stop and free-sliding units ** Fixed-pin units

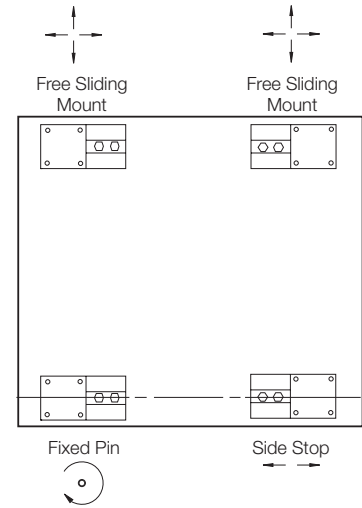
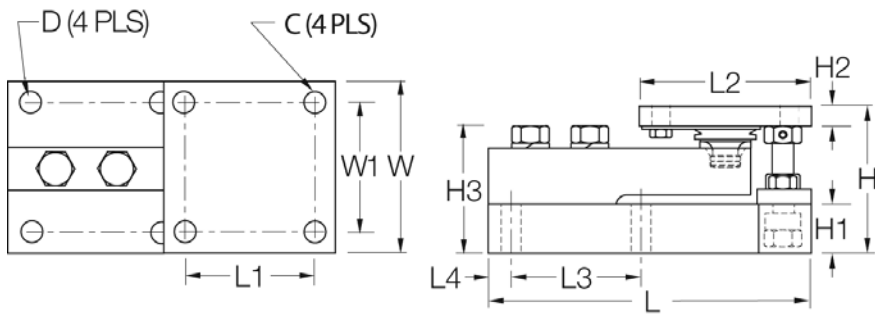

VESSEL ARRANGEMENT

When arranged as illustrated, the vessel is fixed at one corner but is able to slide freely as indicated. This ensures there is minimal side loading on the cells and at the same time the vessel is self-checking. The unique, patented blind load hole technology used in these mounts introduces the load at the neutral axis of the load cell which helps minimize the effects of side loads.

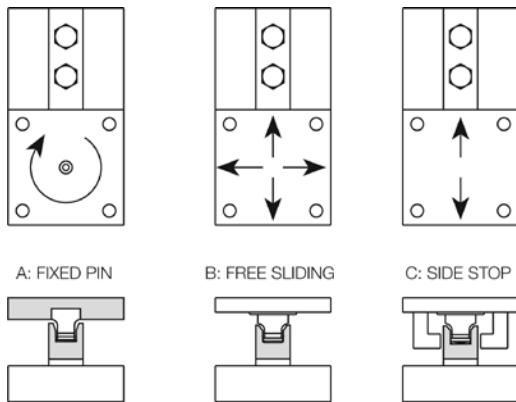

A: FIXED PIN

B: FREE SLIDING

C: SIDE STOP

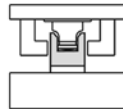
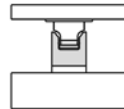
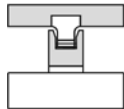

Fixed-pin Mount

Free-sliding Mount

Side-stop Mount

WEIGH MODULES